



# Installation Guide

## Outdoor WPC Cladding

## INSTALLATION GUIDE

### OUTDOOR WPC WALL CLADDING

#### *Important Information*

*It is important to employ safe working practices and use safety protection gear when installing wall cladding, such as protective eyewear and clothing, safe footwear, and respiratory protection gear.*

*We recommend that you use professional installers for our products. Installation must be done in accordance with installation practices. Incorrect installation or preparation of the wall will void your warranty.*

*Please read through the entire Installation Guide before you begin installing your new wall cladding.*

#### **Storage and handling**

- ❖ Serfloor's WPC Cladding is designed to replicate the natural variation in timber products. We recommend purchasing all pieces required for your project at the same time, to avoid colour variation due to batch differences.
- ❖ The cladding pieces should always be stored in a cool and dry place, out of direct sunlight.
- ❖ They must be stored on a level horizontal surface that supports the entire length of the product; this is to ensure that the cladding piece do not bend.
- ❖ Protective gloves should be worn while handling, cutting, and installing the WPC cladding pieces. We recommend a minimum of two people to carry and install the pieces, ensuring it is within their physical capabilities.
- ❖ Extreme temperature changes will cause the pieces to expand and contract, please ensure that they are given time to acclimatise to the outside temperature prior installation. Do not install in extreme temperatures.

#### **Required Tools and Equipment**

- ❖ Protective equipment (long sleeves, gloves, safety glasses, ear protection, and dust mask).
- ❖ Tool set (tape measure, spirit level, and pencil).
- ❖ Cutting tool (fine toothed wood blade and a circular saw).
- ❖ Power tool (drill).
- ❖ Screws (8mm x 20mm stainless steel or galvanised flat head timber screws (length of screw will depending on baton thickness).
- ❖ Clips (optional).

## INSTALLATION GUIDE

### OUTDOOR WPC WALL CLADDING

#### Preparation of the surface

- ❖ Ensure your application surface is clean, dry, level, and flat prior to installation. A badly prepared surface will affect the results of installation.
- ❖ Plan out the direction the cladding will be installed; if installing the piece vertically, your batons must be installed horizontally, and vice versa.
- ❖ We recommend using 50 x 25 mm timber batons suitable for outdoor use as support to install the cladding pieces onto, ensuring they are installed no more than 500mm apart from each other, and covering the entire length and width of the area that will be cladded.
- ❖ Where two cladding pieces will meet at a butt end, two batons are needed to create a double joist, ensuring a 5mm gap is left between both batons.
- ❖ We recommend edging the perimeter with batons to ensure no visible gaps between the wall and the cladding, as well as preventing debris and pests from entering between the wall and the cladding.

*Note: Please ensure that your batons are at least 25mm thick to allow for sufficient air flow between the wall and the cladding pieces.*

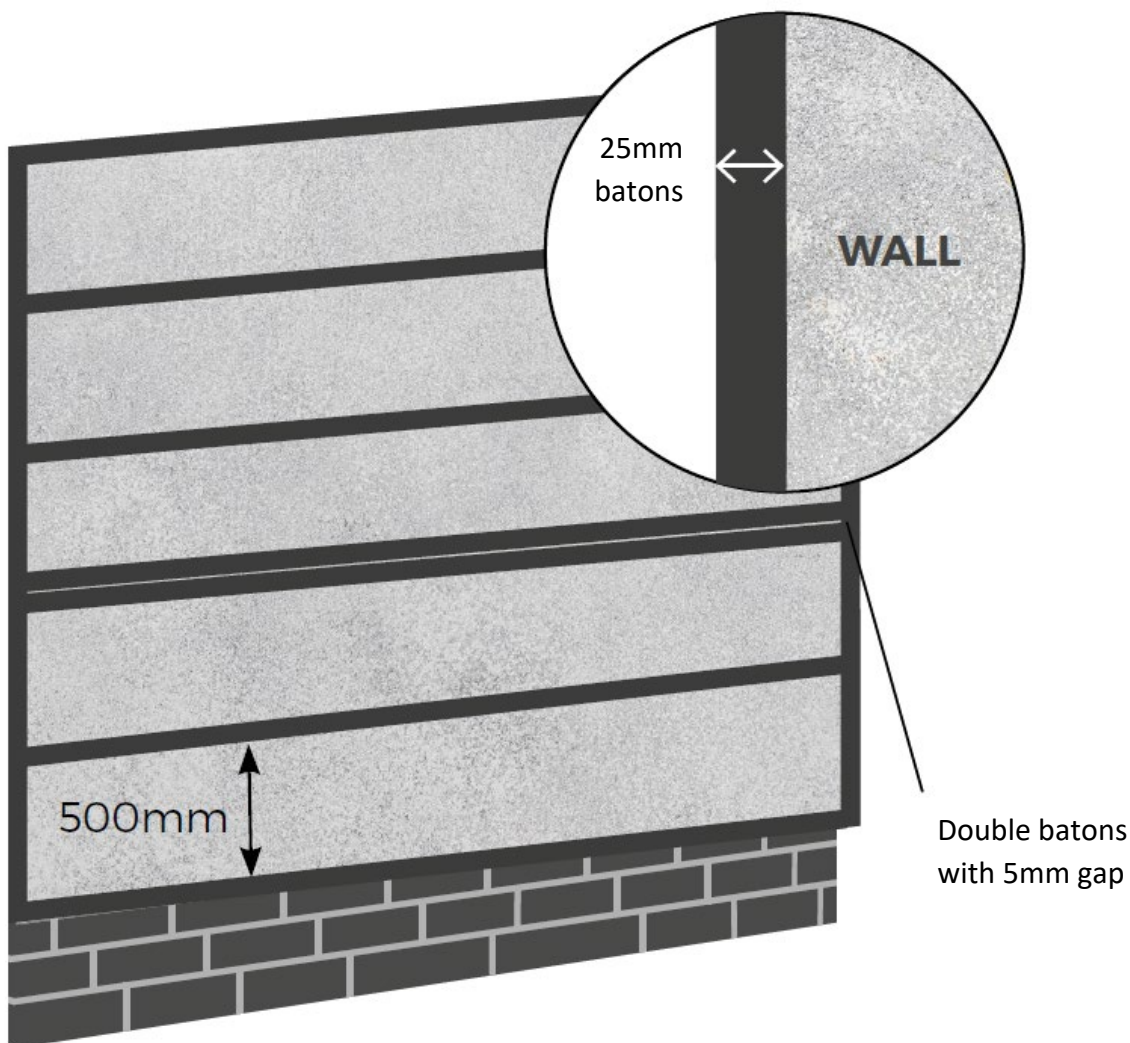

## INSTALLATION GUIDE

### OUTDOOR WPC WALL CLADDING

## Installation

### Step 1

- ❖ Lay out the different pieces prior installation to ensure a good balance of colours.
- ❖ Inspect each piece to ensure there is no defects (if defective pieces are installed, the warranty will be void in respect to those pieces).

### Step 2

- ❖ Starting from the corner, place the first piece ensuring it is level and that the grooved lip faces the direction you will be installing. Pre-drill, then screw the grooved lip of the profile to the baton, starting at the top and ensuring that the piece is secured to every baton underneath.
- ❖ Ensure that the screw head sits flush within the groove, so that the next piece can connect seamlessly.

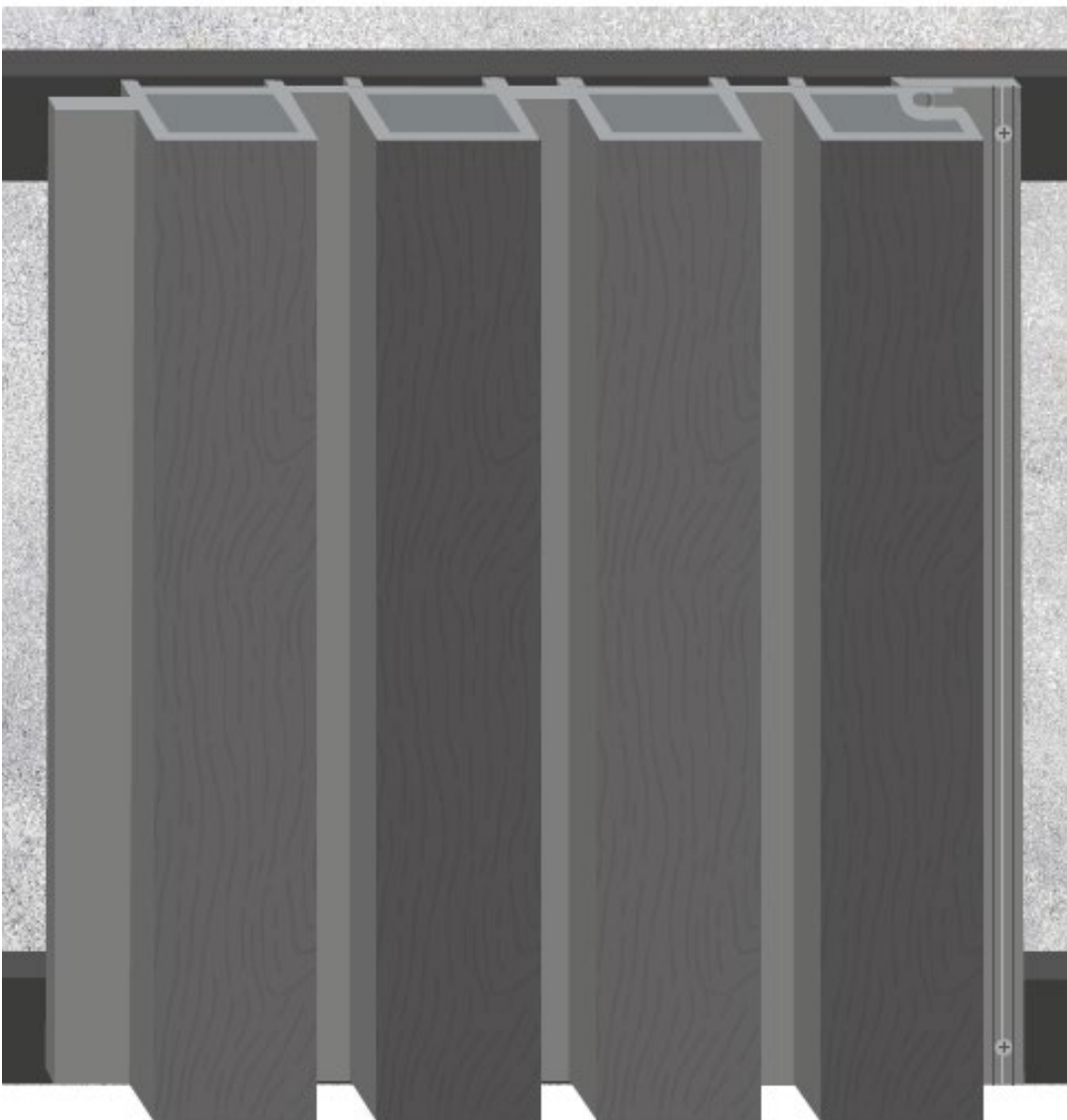

## INSTALLATION GUIDE

### OUTDOOR WPC WALL CLADDING

#### Step 3

- ❖ Repeat the process until the wall is complete.
- ❖ If the cladding is being installed around a corner, cut the piece to the appropriate size to finish the corner.

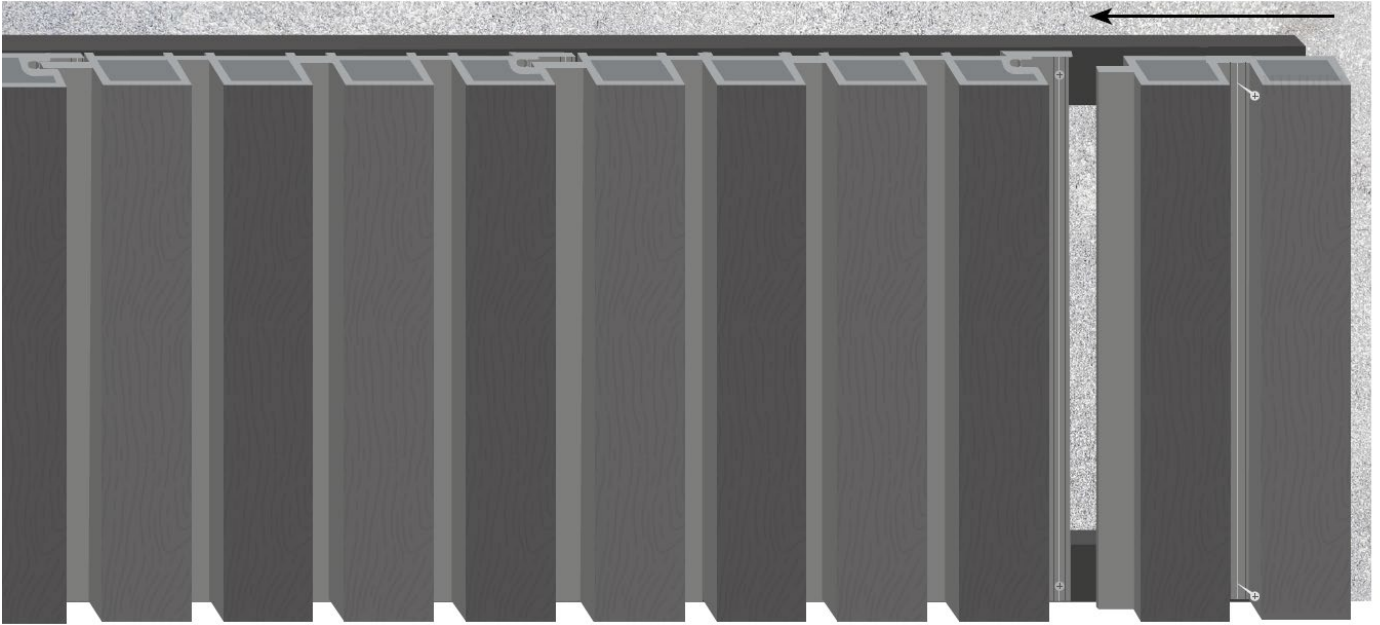

- ❖ Where cladding pieces meet at a butt end, a 5mm gap must be left to allow for expansion during extreme temperature.

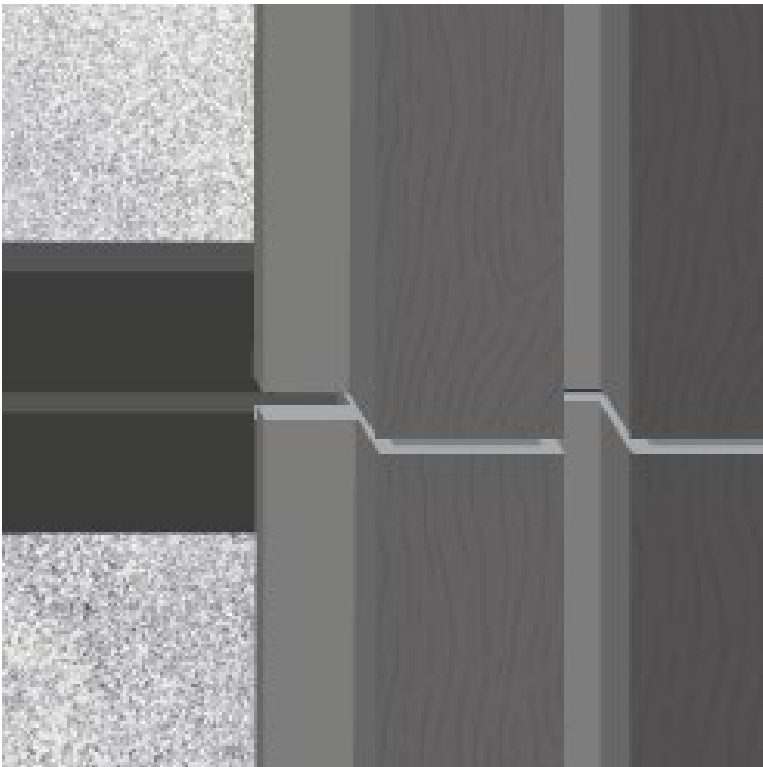

5mm gap at butt end

## INSTALLATION GUIDE

### OUTDOOR WPC WALL CLADDING

#### Finishing

- ❖ You may use the matching corner piece along to top, bottom or sides of your installation for a finished look.
  - If installing a corner piece at the bottom, we recommend to also install a corner piece at the top to avoid water becoming trapped.
- ❖ Pre-drill the corner piece and secure along the length using the same screws used during the installation of the cladding pieces.
- ❖ When joining two corner pieces at a but end, ensure a 5mm expansion gap is left

